

CABLE PULLING DATA						
NOTE: USE POLYESTER PULLING TAPE (CODE NO. 56-0154) TO INITIATE CABLE PULLING						
CABLE RUN LOC.	CALCULATED PULLING TENSION	PREFERRED DIRECTION OF PULL	MAXIMUM ALLOWABLE PULLING TENSION-GRIP	MAXIMUM ALLOWABLE PULLING TENSION-EYE	ACTUAL PULLING TENSION	ACTUAL DIRECTION OF PULL
2	243 lbs.	LOC. 1 - LOC. 3	1688 lbs.	1688 lbs.	lbs.	LOC. - LOC.

### Underground Service Alert



Call: TOLL FREE  
811

**TWO WORKING DAYS BEFORE YOU DIG**

PG&E GAS CONFLICTS IDENTIFIED FOR THIS PROJECT  
GAS PLATS: 45-D15  
PG&E GAS FACILITIES IN CONFLICT W/ EXCAVATION AT LOC(S):  
NONE  
PG&E GAS FACILITIES IN PROXIMITY W/ EXCAVATION AT LOC(S):  
#2

### NOTES:

- THIS IS AN APPLICANT DESIGN AND INSTALL PROJECT. APPLICANT SHALL TRENCH, BACKFILL & INSTALL ALL SUBSTRUCTURES INCLUDING ELECTRIC DISTRIBUTION & SERVICE FACILITIES. APPLICANT CONTRACTOR WILL PERFORM ANY AND ALL REQUIRED TRENCH, EXCAVATION AND BACKFILL, INCLUDING THOSE ITEMS REQUIRED TO MAKE READY FOR P.G. & E. "TIE-INS". (A.I.F.) APPLICANT INSTALLED FACILITY TAGS ARE REQUIRED AT ALL SPLICE AND CONNECTION POINTS. THESE TAGS SHALL BE SIGNED AND DATED ON THE DATE OF INSTALLATION.
- P.G. & E. SHALL INSPECT ALL WORK PERFORMED BY APPLICANT AND PERFORM ALL HOT TIE-INS TO EXISTING FACILITIES AS REQUIRED.
- THIS DESIGN WAS BASED ON ECONOMIC LIMITS. CALCULATIONS ARE BASED ON MAIN SWITCH SIZE OF 200 AMP - 10,000 SC AMPS MAX. AND 3000 SQ. FT. HOMES WITH 3 TON A/C, CLIMATE ZONE: 5.
- ALL SERVICES SHALL BE 4/0 AL TRIPLEX IN 3" DUCT. ALL CABLE LENGTHS INCLUDE TAILS. ALL CONDUIT LENGTHS ARE MEASURED IN TRENCH FEET.
- RETAINING WALLS DETERMINED TO BE NECESSARY BY P.G. & E. INSPECTOR ARE THE APPLICANT'S RESPONSIBILITY.
- ALL PRIMARY CONDUITS SHALL HAVE A MINIMUM 30" COVER (36" IN THE STREET).
- ALL PRIMARY CONDUITS SHALL ENTER ENCLOSURES PERPENDICULAR TO END WALLS. (UNLESS NOTED OTHERWISE).
- ALL HORIZONTAL 4", 5" & 6" PRIMARY CONDUIT BENDS SHALL HAVE A MINIMUM 5 FT. RADIUS. ALL HORIZONTAL 2" & 3" PRIMARY CONDUIT BENDS SHALL HAVE A MINIMUM 3 FT. RADIUS.
- ALL SECONDARY & SERVICE CONDUITS SHALL ENTER SECONDARY BOXES &/OR PEDESTALS FROM THE BOTTOM UTILIZING 90° BENDS & 24" RADIUS.
- UTILIZE NATURAL BENDS WHENEVER POSSIBLE.
- DO NOT EXCEED 300 DEGREES IN CONDUIT BENDS IN ANY SINGLE RUN
- P.G. & E. SHALL DO ALL WORK AT 800 SERIES LOCATIONS.
- APPLICANT SHALL OBTAIN ALL NECESSARY PERMITS.
- APPLICANT SHALL GRANT ALL NECESSARY EASEMENTS TO P.G. & E. AT NO ADDITIONAL COST.
- CALL U.S.A. AT 1-800-227-2600 AT LEAST 48 HOURS PRIOR TO DIGGING.
- BEFORE BEGINNING WORK, PLEASE CALL P.G. & E. UNDERGROUND INSPECTOR 24 HOURS IN ADVANCE. "WORK NOT PROPERLY INSPECTED WILL BE REJECTED".

**PG&E APPLICANT DESIGN APPROVAL**  
PG&E's plan check does not release the Applicant from responsibility to construct the facilities according to PG&E's Standards. In the event of conflict during construction, PG&E Standards will take precedence.  
Electric ADE: Chuck Nunes Desk Phone: 925-459-6032  
Approval Signature: *Chuck Nunes*  
Date: 03/23/2020

### ELEC. NOTES:

- PRIMARY SPLICE BOXES TO BE INSTALLED PER P.G. & E. DWG. 062000 SHTS. 1-26. INSTALLATION TO INCLUDE GROUND RODS.
  - SECONDARY SPLICE BOXES TO BE INSTALLED PER P.G. & E. DWG. 028028 SHTS. 1-15.
  - UNDERGROUND CONDUITS TO BE INSTALLED PER P.G. & E. DWG. 062288 SHTS. 1-25. BELL ENDS ARE TO BE INSTALLED ON ALL CONDUITS THAT ARE TERMINATED IN A SECONDARY SPLICE BOX. TEMPORARY END CAPS TO BE INSTALLED ON ALL CONDUITS.
- SEE "ELECTRIC & GAS SERVICE REQUIREMENTS" (GREEN BOOK) FOR OTHER DETAILS.

**\*TX VAULT INSTALLATION**  
WATER TABLE AND CHLORIDE REPORTS MEET THE REQUIREMENT FOR INSTALLATION OF SUBSURFACE TRANSFORMERS. WATERPROOFING NOT REQUIRED.  
(PER DRAWING 072149 IN UG-1 GENERAL SECTION OF GREENBOOK DATED 12/1/19)

### LEGEND

INSTALL	DESCRIPTION	
— P2 —	PRIMARY CONDUCTOR/CABLE - (2) 1/0AL EPR-CONC-ENCAP PE IN 4" DUCT	
— S —	SECONDARY CONDUCTOR/CABLE IN DUCT (SIZE AS SHOWN)	
— D3 —	EMPTY 3" DUCT	
— SV —	SERVICE CONDUCTOR/CABLE IN DUCT (SIZE AS SHOWN)	
— SL —	STREETLIGHT CONDUCTOR IN DUCT (SIZE AS SHOWN)	
EXISTING	DESCRIPTION	
—	ELECTRIC CONDUCTOR/CABLE - SIZE AS SHOWN	
INSTALL	EXISTING	DESCRIPTION
●	●	SUB-SURFACE TX IN 4'x6'-6'x5" ENCLOSURE
□	□	17"x30" SECONDARY SPLICE BOX
●	●	RISER
×	×	CUT-OUT
○	○	JOINT POLE
△	△	OVERHEAD TRANSFORMER
⊞	⊞	OVERHEAD SWITCH
Ⓜ	Ⓜ	RECLOSER
⊞	⊞	STATE #3-1/2 STREETLIGHT PULL BOX
⊞	⊞	91W LED STREETLIGHT (LS2A)
⊞	⊞	0H 65W LED STREETLIGHT (LS2A)
⊞	⊞	113W LED STREETLIGHT (LS2A)

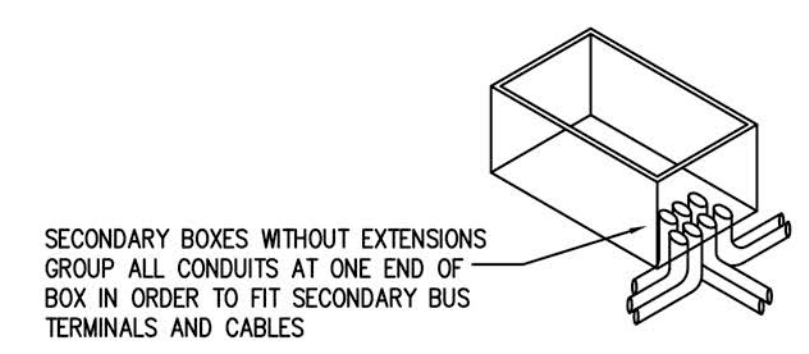

SECONDARY BOX DETAIL

PM #35112862  
NOT. #116473530  
PRIMARY PLAT SHEET: D-1023  
MAINLINE FEEDER: LAKEWOOD 1104  
PRIMARY VOLTAGE AREA: 1  
INSULATION DISTRICT: B  
NON-CORROSION AREA  
CLIMATE ZONE: X (SI)  
SNOW LOADING: LIGHT



APPROVAL	DATE	REVISIONS	NO.

**SUNSHINE DESIGN**  
AN IUGCC CO.  
UTILITY DESIGN ENGINEERS  
AND CONSULTANTS  
324 CAMPUS LN., STE B  
FAIRFIELD, CA 94534  
(707) 429-8688  
FAX (707) 429-8684

**REGISTERED PROFESSIONAL ENGINEER**  
WILLIAM M. PEZONER  
No. 28814  
9-31-20  
CIVIL  
STATE OF CALIFORNIA

**ELECTRIC PLAN**  
1728 SAN LUIS ROAD  
THE ADDRESS COMPANY  
WALNUT CREEK CALIFORNIA

DESIGNED: DL  
CHECKED: SA  
SCALE: 1"=30'  
DATE: 1/27/20  
JOB NO. 933-18-D  
SHEET NO. E1  
OF 1

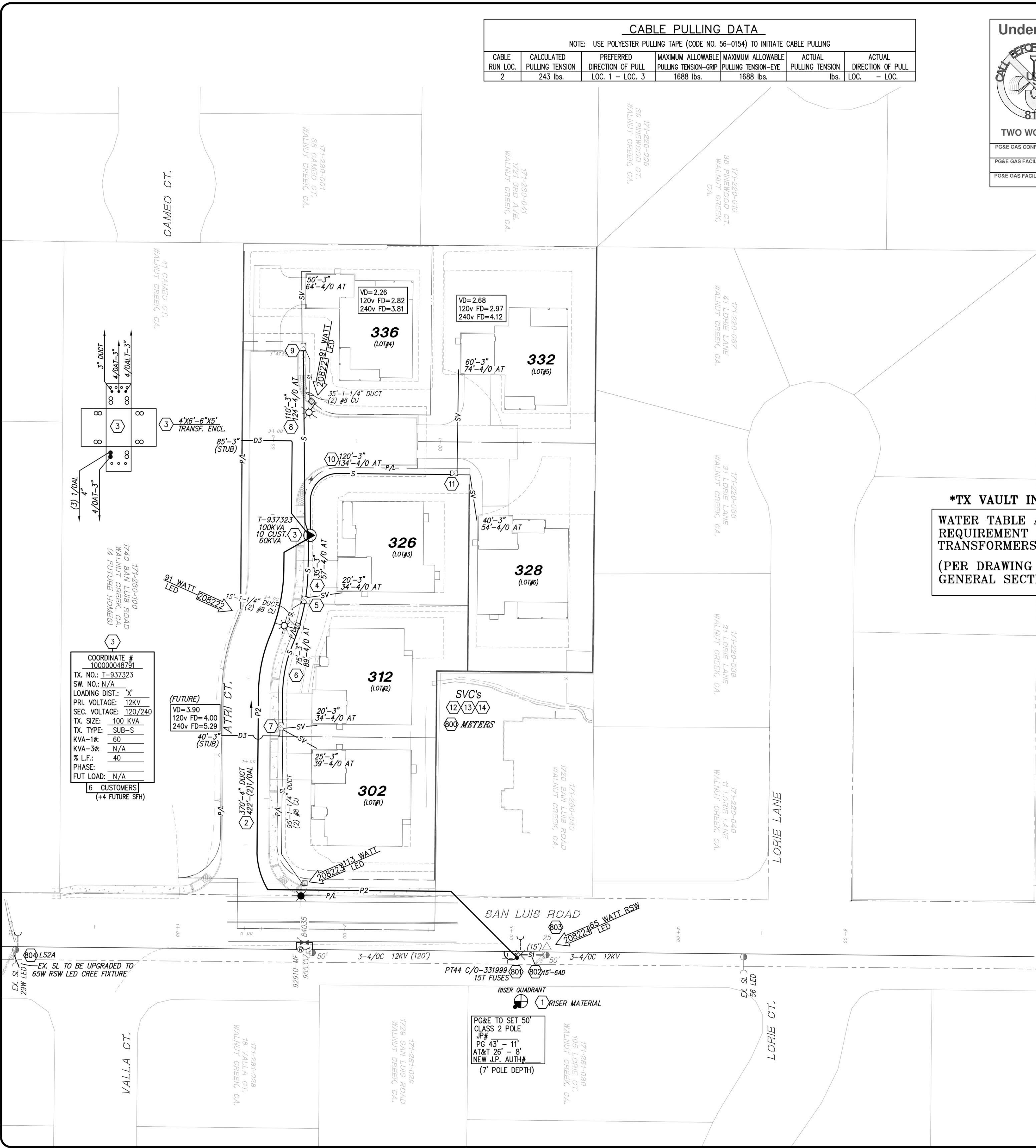

COORDINATE #  
100000048791  
TX. NO.: T-937323  
SW. NO.: N/A  
LOADING DIST.: 'X'  
PRI. VOLTAGE: 12KV  
SEC. VOLTAGE: 120/240  
TX. SIZE: 100 KVA  
TX. TYPE: SUB-S  
KVA-1φ: 60  
KVA-3φ: N/A  
% L.F.: 40  
PHASE: N/A  
FUT LOAD: N/A  
6 CUSTOMERS  
(+4 FUTURE 5FH)

PG&E TO SET 50'  
CLASS 2 POLE  
JP#  
PG 43' - 11"  
AT&T 26' - 8"  
NEW J.P. AUTH#  
(7' POLE DEPTH)